



## บันทึกข้อความ

คณะวิทยาศาสตร์  
SCO.....7836.....  
วันที่ 28 ธ.ค. 2566  
เวลา 14.19น.

กองวิเทศสัมพันธ์

ที่ ๒๖.๗๘.๐๑๖ / ๒๓๓๙ วันที่ ๒๗ ธ.ค. ๒๕๖๖

เรื่อง ประชาสัมพันธ์โครงการนักศึกษาแลกเปลี่ยน ณ Kyushu University

เรียน ผู้อำนวยการกองวิเทศสัมพันธ์

สมควรส่งคณะวิศวกรรมศาสตร์ คณะวิทยาศาสตร์ คณะสิ่งแวดล้อมและทรัพยากรศาสตร์ คณะสังคมศาสตร์และมนุษยศาสตร์ คณะศิลปศาสตร์ คณะเทคโนโลยีสารสนเทศและการสื่อสาร วิทยาเขตกาญจนบุรี และวิทยาลัยนานาชาติ เพื่อประชาสัมพันธ์ Kyushu University Exchange Program – Fall 2024 สำหรับนักศึกษาระดับปริญญาตรีและบัณฑิตศึกษา ชั้นปีที่ 2 ขึ้นไป ที่สนใจเข้าร่วมกิจกรรมแลกเปลี่ยน ณ Kyushu University ประเทศญี่ปุ่น 1 ภาคการศึกษา ระหว่างเดือน ตุลาคม 2567 - มีนาคม 2568 หรือ 1 ปีการศึกษา ตุลาคม 2567 - กันยายน 2568

รายละเอียดโครงการ

1. Schools and Graduate Schools เป็นการแลกเปลี่ยนนักศึกษาตามปกติ โดยรายวิชาส่วนใหญ่เป็นภาษาญี่ปุ่น โดยจะมีรายวิชาภาษาอังกฤษ ในสาขาวิศวกรรมศาสตร์ เกษตรศาสตร์ และ Interdisciplinary Science & Innovation และระดับบัณฑิตศึกษา <https://www.isc.kyushu-u.ac.jp/intlweb/en/student/english> (JLPT N1 / TOEFL iBT 79 / IELTS 6.0)

2. Emerging Leaders in Science (Q-PELS) เฉพาะสาขาวิทยาศาสตร์ และบัณฑิตศึกษาในสาขา Science, Mathematics, Systems Life Sciences และ Mathematics for Innovation (TOEFL iBT 80 / IELTS 6.0)

1. ถือสัญชาติไทยและเป็นนักศึกษาระดับปริญญาตรีชั้นปีที่ 2 ขึ้นไป หรือระดับบัณฑิตศึกษา

2. ได้รับ GPA ไม่ต่ำกว่า 3.20

3. มีผลสอบภาษาอังกฤษตามที่กำหนด (TOEFL iBT / IELTS หรือ Cambridge English: First (FCE) Grade B / CEFR certificate average grade of B2 (ต้องมีประกาศนียบัตรเท่านั้น ไม่รับผลหน้าเว็บไซต์) และ DAAD Scholarships: Qualified Applicant (B2 or equivalent)

4. มหาวิทยาลัยมหิดลเสนอชื่อนักศึกษาเข้าร่วมได้ 2 คน และ Kyushu University เป็นผู้พิจารณาตอบรับหรือปฏิเสธการเข้าร่วมโครงการ

นักศึกษาที่ได้รับการตอบรับให้เข้าร่วมกิจกรรมแลกเปลี่ยนสามารถสมัครขอรับทุนสนับสนุน (partial scholarship) จากมหาวิทยาลัยได้

ขอให้ส่วนงานเสนอรายชื่อนักศึกษาที่ประสงค์เข้าร่วมกิจกรรมแลกเปลี่ยนพร้อมข้อมูลดังต่อไปนี้

- โครงการที่ต้องการสมัคร - สำเนาหนังสือเดินทาง - สำเนา transcript

- สำเนาผลสอบภาษาอังกฤษ - อีเมล

มายังกองวิเทศสัมพันธ์ ภายในวันที่ 8 กุมภาพันธ์ 2567 โดยสามารถจัดเตรียมเอกสารการยื่นสมัครออนไลน์ได้ตามรายการเอกสารที่แนบมานี้ (ไม่รับการเสนอชื่อทางอีเมล) และผู้ที่ได้รับพิจารณาเสนอชื่อ จะได้รับ link สำหรับ log in เข้าไปยื่นเอกสารการสมัครออนไลน์ ต่อไป (ระบบปิดวันที่ 10 มีนาคม 2567)

พิจิไค  
๒๕ ธ.ค. ๖๖

  
๒๕ ธ.ค. ๖๖

(นางสาววรรณพิมล เสนาแพทย์ภาคร)  
ผู้อำนวยการกองวิเทศสัมพันธ์





# Kyushu University Fact Sheet

(for University-Wide Student Exchange Program)

※The information below is subject to change.

As of November, 2023

General Information	
Mailing Address	Kyushu University #401, Center Zone 4, 744 Motooka, Nishi-ku Fukuoka City, JAPAN 819-0395
Contact Person	Inbound Yuko HAYASHI (Ms.) / exchange@jimu.kyushu-u.ac.jp Outbound Maaya MOTOYOSHI (Ms.) / ryugaku@jimu.kyushu-u.ac.jp
Website	<a href="https://www.kyushu-u.ac.jp/en/">https://www.kyushu-u.ac.jp/en/</a>
Campus	<a href="https://www.kyushu-u.ac.jp/en/campus">https://www.kyushu-u.ac.jp/en/campus</a>
Application Information (common for all programs)	
Application Procedure	<p>Kyushu University application method consists of the following two steps, nomination period by partner universities and web application period completed by the nominated students.</p> <p>International exchange students may choose one of the following programs; 1) School; 2) Graduate School; 3) JTW; 4) JLCC or 5) Q-PELS</p> <p><u>Please send a nomination sheet firstly to us by the each designated date.</u> For JTW/JLCC: January 10th, 2024 For Undergraduate/ Graduate program or Q-PELS: February 10th, 2024</p> <p>After that, nominated students are required to complete the online submission by the each designated date. (*Details will be notified after nomination.) For JTW/JLCC: February 10th, 2024 For Undergraduate/ Graduate program or Q-PELS: March 10th, 2024</p> <p><a href="https://www.isc.kyushu-u.ac.jp/intlweb/en/admission/exchangetop">https://www.isc.kyushu-u.ac.jp/intlweb/en/admission/exchangetop</a></p>
Credit	2 credits are usually awarded for each course of 30 hours (2 hour session x 15), while 1 credit is awarded for each language course of 30 hours.
Courses NOT Open to Exchange Students	<p>Practical courses such as Medicine, Pharmacy, Dental Sciences are not open to exchange students.</p> <p>Courses offered by Kyushu University Business School (QBS) are open only to exchange students who are enrolled in QBS.</p>
Japanese Language Courses	<p>Japanese language courses are provided for international students enrolled at Kyushu University. Please visit the following website for more details.</p> <p>Japanese Training Courses (JTCs): For those who do not need credits for Japanese Language Courses. (*Upon successful completion, a certificate of attendance will be provided. The possibility of credit recognition can be discussed with your home university if you wish to pursue accreditation.)</p> <p>Japanese Academic Courses (JACs): For those who need credits for Japanese Language Courses.</p> <p><a href="https://isc.kyushu-u.ac.jp/center/international/japaneselang/">https://isc.kyushu-u.ac.jp/center/international/japaneselang/</a></p>
Transcripts Sent to Home University	Late October for Spring Admission, Late April for Fall Admission

## Application Information for Schools and Graduate Schools

Eligibility	<ul style="list-style-type: none"> <li>• Applicants must have studied at least 1 year in the degree program of home university.</li> <li>• Required GPA 3.2/4.0 *Refer to the page 5.</li> <li>• Undergraduate students for Schools. Graduate students for Graduate Schools</li> </ul> <p>[For those who wish to study in Japanese]</p> <ul style="list-style-type: none"> <li>• JLPT N1</li> </ul> <p>[For those who wish to study in English]</p> <ul style="list-style-type: none"> <li>• TOEFL iBT 79, IELTS 6.0 or equivalent</li> </ul> <p>A score of TOEFL iBT or IELTS is preferable. However, we may accept one of the certificates listed below as an alternative.</p> <ol style="list-style-type: none"> <li>1) Cambridge English: First (FCE) Grade B</li> <li>2) CEFR (Common European Framework of Reference for Languages): average grade of B2</li> <li>3) DAAD Scholarships: Qualified Applicant (B2 or equivalent)</li> </ol> <p>*TOEIC or EF-SET(<a href="https://www.efset.org/">https://www.efset.org/</a>) Certificate is unacceptable.</p> <p>Also, if any of the following conditions apply, applicants are exempt from submitting a certificate of English proficiency:</p> <ol style="list-style-type: none"> <li>1) An applicant who is currently enrolled in an undergraduate/graduate program at a university in one of the countries listed below.</li> <li>2) An applicant who completed high school or university education in one of the countries listed below.</li> </ol> <p>Australia, Canada, New Zealand, South Africa, Singapore, United Kingdom, United States</p>
Website	<a href="https://www.kyushu-u.ac.jp/en/faculty/undergraduate/">https://www.kyushu-u.ac.jp/en/faculty/undergraduate/</a>
Campus	Ito Campus, Ohashi Campus, Chikushi Campus or Hospital Campus
Language in Use	<p>Japanese</p> <p>※There are courses conducted in English at School of Engineering, School of Agriculture, School of Interdisciplinary Science &amp; Innovation and all graduate school. However, please be sure to check if there are enough English courses to take before application since there are no or very limited number of courses in some study field.</p> <p>Courses are available in English→ <a href="https://www.isc.kyushu-u.ac.jp/intlweb/en/student/english">https://www.isc.kyushu-u.ac.jp/intlweb/en/student/english</a></p>
Syllabus	<a href="https://www.kyushu-u.ac.jp/en/faculty/class/learning/syllabus/department">https://www.kyushu-u.ac.jp/en/faculty/class/learning/syllabus/department</a>
Academic Calendar	<a href="https://www.kyushu-u.ac.jp/en/faculty/schedule">https://www.kyushu-u.ac.jp/en/faculty/schedule</a>
Exchange Period	1 year (April-March), 1 year (October-September), 1 Semester (April- September), 1 Semester (October-March) *QBS offers only 1 Semester (October- March)
Nomination Deadline	September 30 for Spring Admission, February 10 for Fall Admission
Application Deadline	October 15 for Spring Admission, March 10 for Fall Admission
Selection Result	Late December for Spring Admission, Late June for Fall Admission



# 3. UNDERGRADUATE SCHOOL / GRADUATE SCHOOL

## [各プログラムの紹介] 3. 学部・大学院

Exchange Period	<ul style="list-style-type: none"><li>• 1 year : April to March / October to September</li><li>• 1 semester : April to September / October to March</li></ul>
Language in Use	Japanese / English. *For details, please refer to page 13.
Eligibilities	<ul style="list-style-type: none"><li>• Applicants must have studied at least 1 year in the degree program of home university.</li><li>• Required GPA 3.2/4.0</li><li>• Language Proficiency For those who study in Japanese: JLPT N1 or equivalent *JLPT N2 would be acceptable for #1 and #4. For those who study in English: TOEFL IBT 79, IELTS 6.0 or equivalent</li></ul>
Outlines	Kyushu University has 12 undergraduate schools and 18 graduate schools, where constantly accept exchange students in order to offer courses or research instruction upon their purpose and/or academic interest. Regarding languages used in classes, Japanese is the medium of instruction at most of undergraduate schools except three, the School of Interdisciplinary Science and Innovation, School of Engineering and the School of Agriculture. It means you can study at Kyushu University as an exchange student by taking courses in English in three undergraduate school mentioned above and all the graduate schools.

留学期間	<ul style="list-style-type: none"><li>• 1年: 4月～翌3月、10月～翌9月</li><li>• 半年: 4月～9月、10月～翌3月</li></ul>
使用言語	日本語または英語 ※詳細については13ページを参照のこと
応募資格	<ul style="list-style-type: none"><li>• 本籍大学において、1年以上正規の学位課程に在籍していること</li><li>• GPA 3.2/4.0以上であること</li><li>• 語学力については以下のとおり 日本語で受講/研究する者は、日本語能力試験N1または同等レベル 英語で受講/研究する者は、TOEFL IBT79点、IELTS6.0点または同等レベル</li></ul>
概要	九州大学には12の学部と18の大学院があり、そこでは交換留学生をコンスタントに受け入れ、学生の留学目的や関心に基づいた講義や研究指導の提供を行っています。 ほとんどの学部では日本語で授業を提供していますが、共創学部、工学部、農学部では英語による授業も実施しています。つまり、上記の3つの学部とすべての大学院では、英語による交換留学が可能です。

## ■ List of Undergraduate Schools / Graduate Schools / 学部・大学院一覧 ■

### ▶ Undergraduate School / 学部

School 名称	Language of Instruction 使用言語		Campus キャンパス	HP
	Japanese 日本語	English 英語		
School of Interdisciplinary Science and Innovation 共創学部		✓	Ito 伊都	
School of Letters 文学部	✓		Ito 伊都	
School of Education 教育学部	✓		Ito 伊都	
School of Law 法学部	✓		Ito 伊都	

School of Economics 経済学部	✓		Ito 伊都	
School of Science 理学部	✓		Ito 伊都	
School of Engineering 工学部	✓	✓	Ito 伊都	
School of Design 芸術工学部	✓		Ohashi 大橋	
School of Agriculture 農学部	✓	✓	Ito 伊都	

\*Practical courses, such as School of Medicine, Dentistry and Pharmaceutical Sciences are not open to exchange students.

※医学部、歯学部、薬学部では、交換留学生は受け入れていません。

### ▶ Graduate School / 大学院

School 名称	Language of Instruction 使用言語		Campus キャンパス	HP
	Japanese 日本語	English 英語		
Graduate School of Humanities 人文科学府	✓	✓	Ito 伊都	
Graduate School of Integrated Sciences for Global Society 地球社会統合科学府	✓	✓	Ito 伊都	
Graduate School of Human Environment Studies 人間環境学府	✓	✓	Ito 伊都	
Graduate School of Law 法学府	✓	✓	Ito 伊都	
Graduate School of Economics 経済学府	✓	✓	Ito 伊都	
Graduate School of Science 理学府	✓	✓	Ito 伊都	
Graduate School of Mathematics 数理学府	✓	✓	Ito 伊都	
Graduate School of Systems Life Sciences システム生命科学府	✓	✓	Ito 伊都	
Graduate School of Medical Sciences 医学府	✓	✓	Hospital (Maldashi) 病院(馬出)	

Graduate School of Dental Science 歯学府	✓	✓	Hospital (Maldashi) 病院(馬出)	
Pharmaceutical Sciences 薬学府	✓	✓	Hospital (Maldashi) 病院(馬出)	
Graduate School of Engineering 工学府	✓	✓	Ito 伊都	
Graduate School of Design 芸術工学府	✓	✓	Ohashi 大橋	
Graduate School of Information Science and Electrical Engineering システム情報科学府	✓	✓	Ito 伊都	
Interdisciplinary Graduate School of Engineering Sciences 総合理工学府	✓	✓	Chikushi (Kasuga City) 筑紫 (春日市)	
Graduate School of Bioresource and Bioenvironmental Sciences 生物資源環境科学府	✓	✓	Ito 伊都	
Graduate School of Integrated Frontier Sciences 統合新領域学府	✓	✓	Ito 伊都	

\*For location of each campus, please refer to the page 2 and the page 3.

※各キャンパスの場所については、2・3ページを参照してください。



Application Information for Kyushu University Program for Emerging Leaders in Science (Q-PELS)	
Eligibility	<ul style="list-style-type: none"> <li>• Applicants must have studied at least 1 year in the degree program of home university.</li> <li>• Required GPA 3.2/4.0 *Refer to the page 5.</li> <li>• (Undergraduate students) School of Science (Graduate students) Graduate School of Science, Graduate School of Mathematics, Graduate School of Systems Life Sciences, Joint Graduate School of Mathematics for Innovation</li> </ul> <p>[For those who wish to study in Japanese]</p> <ul style="list-style-type: none"> <li>• JLPT N2 or higher</li> </ul> <p>[For those who wish to study in English]</p> <ul style="list-style-type: none"> <li>• TOEFL IBT 80 or higher</li> <li>• IELTS 6.0 or higher</li> <li>• Cambridge English with CEFR B2 level or higher</li> <li>• Official document (certificate/letter) which proves English is the medium of instruction at their school/graduate school/faculty</li> </ul> <p>If any of the following conditions apply, applicants are exempt from submitting a certificate of English proficiency:</p> <ol style="list-style-type: none"> <li>1) An applicant who is currently enrolled in an undergraduate/graduate program at a university in one of the countries listed below.</li> <li>2) An applicant who completed high school or university education in one of the countries listed below.</li> </ol> <p>Australia, Canada, New Zealand, South Africa, Singapore, United Kingdom, United States</p>
Outline of Q-PELS	Please refer to the attachement.
Campus	Ito Campus
Language in Use	Japanese/English
List of Host Labs	Please refer to the attachement.
Academic Calendar	<a href="https://www.kyushu-u.ac.jp/en/faculty/schedule">https://www.kyushu-u.ac.jp/en/faculty/schedule</a>
Exchange Period (Three Options)	(TYPE1) Up to 3 months: Applicants will arrange the period with the host lab. (TYPE2) 1 semester: April to August / October to February (TYPE3) 1 year: April to February / October to August
Nomination Deadline	September 30 for Spring Admission, February 10 for Fall Admission
Application Deadline	October 15 for Spring Admission, March 10 for Fall Admission
Selection Result	Late December for Spring Admission, Late June for Fall Admission

# 4. Q-PELS

## (Kyushu University Program for Emerging Leaders in Science)

【各プログラムの紹介】 4. 研究型留学プログラム



Exchange Period (Three Options)	<p>[TYPE 1] Up to 3 months: Applicants will arrange the period with the host lab.</p> <p>[TYPE 2] 1 semester: April to August / October to February</p> <p>[TYPE 3] 1 year : April to February / October to August</p>
Language in Use	Japanese / English
Eligibilities	<ul style="list-style-type: none"> <li>• Must have studied at least 1 year in the degree program of home university.</li> <li>• Required GPA 3.2/4.0</li> <li>• Language Proficiency                             <ul style="list-style-type: none"> <li>[For those who study in Japanese] JLPT N2 or equivalent</li> <li>[For those who study in English] TOEFL IBT 80, IELTS 6.0 or equivalent</li> </ul> </li> </ul>
Overviews	<p>Kyushu University has launched a research-oriented exchange program, Q-PELS, for graduate and undergraduate students beginning in the fall enrollment of 2023. As of March 2023, the program is hosted by five faculties: the School of Science, the Graduate School of Science, the Graduate School of Mathematics, Graduate School of Systems Life Sciences, and the Joint Graduate School of Mathematics for Innovation.</p> <p><small>*We will expand the host labs in faculties and fields other than those listed above. *If you wish to join this program with TYPE1 (up to 3 months), please contact the <a href="mailto:exchange@jimu.kyushu-u.ac.jp">exchange@jimu.kyushu-u.ac.jp</a> beforehand.</small></p>

留学期間 (3タイプ)	<p>[タイプ1] 3ヶ月まで: 期間については受入れ教員と調整</p> <p>[タイプ2] 半年: 4月~8月、10月~翌2月</p> <p>[タイプ3] 1年: 4月~翌2月、10月~翌8月</p>
使用言語	日本語または英語
プログラムの 応募資格	<ul style="list-style-type: none"> <li>• 本籍大学において、1年以上正規の学位課程に在籍していること</li> <li>• GPA 3.2/4.0以上であること</li> <li>• 語学力については以下のとおり                             <ul style="list-style-type: none"> <li>日本語で受講／研究する者は、日本語能力試験N2または同等レベル</li> <li>英語で受講／研究する者は、TOEFL IBT 80点、IELTS 6.0点または同等レベル</li> </ul> </li> </ul>
概要	<p>九州大学は、2023年秋学期から大学院生と学部生を対象とした研究型交換留学プログラム「Q-PELS」を開始しました。2023年3月現在、理学部、理学府、数理学府、システム生命科学府、マス・フォア・イノベーション連携学府で受け入れています。 (今後、上記以外の部局・分野にも受入研究室を拡大していく予定です。)</p> <p><small>※なお、タイプ1 (3ヶ月まで) を希望する場合は、事前以下まで問い合わせください。 <a href="mailto:exchange@jimu.kyushu-u.ac.jp">exchange@jimu.kyushu-u.ac.jp</a></small></p>



### Regarding Grade Point Average (GPA)

Kyushu University uses Grade Point Average (GPA) on a 4.0 scale for academic evaluation. This scheme, as defined in the table below, is a credit-weighted average of grading points. The minimum requirement of all applicants (for School, Graduate School, JTW, JLCC and Q-PELS) is a GPA 3.2.

Grade Point	Assessment	Percentile Scale
4	Excellent	90 - 100
3	Good	80 - 89
2	Fair	70 - 79
1	Pass	60 - 69
0	Fail	0 - 59

If academic achievements are rated using a different system, applicants are requested to submit supplemental documentation which shows the scores converted into GPA on a 4.0 scale and explain how to calculate them, along with official transcript. This supplemental documentation is necessary to assess whether applicants satisfy the minimum requirement as exchange students.

### Miscellaneous Information

Support Service for International Students	<p>Kyushu University offers various kind of support for international students, which is beneficial for new incoming students as well.</p> <p>Regarding Visa/Certificate of Eligibility for Status of Residence (CoE), the relevant information, how to apply for, will be provided to successful applicants.</p> <p><a href="https://www.isc.kyushu-u.ac.jp/intlweb/en/student/visa">https://www.isc.kyushu-u.ac.jp/intlweb/en/student/visa</a></p> <p>*Japanese immigration law stipulates that international students with "student" visa have to spend at least ten hours in class every week.</p>
Housing	<p>On campus dormitories are available for exchange students.</p> <p><a href="https://www.isc.kyushu-u.ac.jp/intlweb/en/student/housing">https://www.isc.kyushu-u.ac.jp/intlweb/en/student/housing</a></p> <p>*If applicants' enrollment period is until September/March, they are required to leave on-campus accommodation before the end of August/February due to the preparation of students coming next semester. Please check the website above for further information.</p>
Estimated Cost of Living per Month	<p>Housing and utilities: 15,000 - 50,000 yen</p> <p>Food: 30,000 yen (lunch at the school cafeteria runs about 400 yen, and students typically prepare their own breakfast and dinner at dormitories)</p> <p>Local transportation: 10,000 yen (individual spending habits may vary)</p> <p>Books and supplies: 5,000 yen (instructors typically provide reading materials in class)</p> <p>Health insurance: 2,000 yen</p> <p>Personal expenses: 20,000 yen (individual spending habits may vary)</p>
Health Insurance	<p>All international students are required to subscribe the National Health Insurance (NHI) Plan during the study period. By paying monthly premiums, subscribers are required to cover only 30% of their medical expenses.</p> <p>*We do recommend, however, that an exchange student considers buying travel insurance for emergency-related evacuation and repatriation costs, which NHI does not cover.</p>

End of Fact Sheet

## **Introduction**

Kyushu University is recognized as a leading science university internationally.

Kyushu University's Program for Emerging Leaders in Science (Q-PELS) is a research-oriented student exchange program for graduate and undergraduate students.

Q-PELS provides students with hands-on experience at a wide range of top-level laboratories\* to enrich their knowledge and skills. We believe students from our prestigious partner universities can make a future research hub by collaborating and networking in this program.

\*Please check the attached list.

## **Eligibility**

Q-PELS applicants must meet the following requirements.

- Applicants must be full-time registered degree-seeking students at their home institution with a student exchange agreement with Kyushu University.
- Applicants must be in excellent academic performance at their home institutions.
- Applicants must be reminded as full-time registered degree-seeking students at their home institution after completing this program.  
(Graduation/completion of a regular course of study at their home universities during participation in this program is not acceptable.)
- Applicants must meet other requirements by the host laboratory or host faculty member.

## **Language Requirements**

Q-PELS applicants must meet one of the following language requirements.

<For English proficiency>

- TOEFL iBT 80 or higher
- IELTS 6.0 or higher
- Cambridge English with CEFR B2 level or higher
- Official document (certificate/letter) which proves English is the medium of instruction at their school/graduate school/faculty.

<For Japanese Proficiency>

- JLPT N2 or higher

## Student Workload

Category Name	TYPE1* 32days - 3months	TYPE2 Semester (15 weeks)	TYPE3 Full-year (30 weeks)
Period	June.2024- Sep.2025	Oct.2024- Feb.2025	Oct.2024- Aug.2025
Contact Hours (i.e. hours you spend in the assigned Lab)	Arrange with their host labs /faculty member	420	840
Supervised Study (Meeting with their supervisor)		20	40
Independent research hours		210	420
Tutorial (Supplementary advised from senior students)		30	60
Preparation hours		40	80
Other Laboratory Activities		30	60
<b>Total Student Workload</b>	N/A	<b>750</b>	<b>1500</b>
Student Workload ECTS Equivalent (25hrs 1ECTS)	N/A	30	60

ECT: European Credit Transfer and Accumulation System

**\*TYPE1: TYPE 1 applicants will arrange with the host lab to determine the length of study abroad, which will be between 32 days and 3 months.**

### <Mandatory Assignment>

- Poster presentation (full-year student)
- Oral presentation (at the end of the exchange term)
- Other assignments as assigned by your host laboratory or faculty member

\*Numbers indicate hours per semester or a full year. On average, daily contact hours will be 5.6 hours. The above ECTS-compliant table can be referred to facilitate credit transfer between Kyushu University and partner institutions.

Note:

- The ECT equivalent will be awarded based on the 'Total Student Workload' when performances are



approved by the committee members.

- Q-PELS students are not required to complete a thesis; however, the activities during the program could be a part of a master/doctoral thesis with permission from an academic advisor)
- Other than Contact hours are estimated that vary by laboratory.

### **Student Status**

- 32 days – 3 months (No credits at KU)  
<Both Graduate and Undergraduate student> Trainee Student or Short-term Visiting Student
- Semester/Full-year  
<Undergraduate student> Special Auditing Student  
<Graduate Student> Special Research Student or Special Auditing Student

Note:

- Special Auditing Students are allowed to take other credited courses at KU.  
(Courses conducted in English) <https://www.isc.kyushu-u.ac.jp/intlweb/en/student/english>  
(Japanese classes for Undergraduate students) <https://isc.kyushu-u.ac.jp/center/jacs/>  
(JTW core courses) <https://isc.kyushu-u.ac.jp/jtw/nonjtw>

### **Completion**

Students who complete the mandatory assignments and are approved by the program's host school/graduate school will be issued a Certificate of Completion signed by the dean of the host school.

Kyushu University Program for Emerging Leaders in Science (Q-PELS)\_AY2024

Course code	Category				Course			Host Laboratory Information			Research Description	Pre-Requisites	Maximum number of participants per period	Keywords
	TYPE1 32Days-3months	TYPE2 Semester Fall/2024	TYPE3 Full-year Fall 2024-Spring 2025	Undergraduate		Graduate	Faculty Member(s)		School/Graduate school	Department				
				Surname	First Name		Surname	First Name						
SC24001	○	○	○	○	○		FUKUDA	Jun-ichi	Science	Physics		1	Soft Matter Physics Liquid Crystal Polymer Glass Supercooled liquid biophysics	
							MATSUI	Jun						
							TARAMA	Mitsusuke						
SC24002	○	○	○	○	○		Inagaki	Shio	Science	Physics		2	Background in Physics, especially mechanics and statistical physics. Complex systems Granular physics Molecular dynamics simulation Experiments	
SC24003	○	○	○	○	○		Tojo	Junji	Science	Physics		1	Experience of general physics experiment and learning of introductory particle physics.	
SC24004	○	○	○	○	○		Ohba	Masaaki	Science	Chemistry		1	Coordination Chemistry Metal-organic framework (MOF) Metal-organic polyhedra (MOP) Functional Material Metal complex-enzyme composite	
							Ohtani	Ryo						
							LeOuay	Benjamin						
SC24005	○	○	○	○	○		Terasaki	Akira	Science	Chemistry		2	Physical chemistry Nanoscience Atoms, molecules, and clusters Laser spectroscopy Mass spectrometry Reaction kinetics	
							Horio	Takuya						
							Arakawa	Masashi						

Kyushu University Program for Emerging Leaders in Science (Q-PELS)\_AY2024

Course code	Category				Course			Host Laboratory Information			Research Description	Pre-Requisites	Maximum number of participants per period	Keywords	
	TYPE1 32days-3months	TYPE2 Semester Fall 2024	TYPE3 Full-year Fall 2024 - Spring 2025	Host Laboratory Information			Department								
				Faculty Member(s) Surname	First Name	School/Graduate school									
SC24006	<input type="checkbox"/>	<input type="checkbox"/>	<input type="checkbox"/>												Chemical Biology Fluorescence imaging Protein chemistry Synthetic fluorophores
							Hori Adechi	Yuichiro Junya	Science Chemical						
SC24007	<input type="checkbox"/>	<input type="checkbox"/>	<input type="checkbox"/>												Nuclear receptor estrogen transcription endocrine-disrupting chemical opioid peptide precursor
							Matsushima	Ayami	Science Chemistry						
SC24008	<input type="checkbox"/>	<input type="checkbox"/>	<input type="checkbox"/>												Space weather Space plasma physics Space and Earth geomagnetism Global electromagnetic fields observation
SC24009	<input type="checkbox"/>	<input type="checkbox"/>	<input type="checkbox"/>												space weather Earth and planetary atmosphere Earth and planetary ionosphere Earth and planetary thermosphere satellite observation model simulation
							Liu	Hubin	Science Earth and Planetary Sciences						



Kyushu University Program for Emerging Leaders in Science (Q-PELS)\_AY2024

Course code	Category			Course			Host Laboratory Information			Research Description	Pre-Requisites	Maximum number of participants per period	Keywords
	TYPE1 32days-3months	TYPE2 Semester Fall 2024	TYPE3 Full-year Fall 2024-Spring 2025	Faculty Member(s)		School/Graduate school	Department						
				Surname	First Name								
SC24010	<input type="checkbox"/>	<input type="checkbox"/>	<input type="checkbox"/>	Hamamura	Natsuko	System Life Science/ Science	Biological Science/Dept of Biology	Due to rapid industrial development, discharge of a wide range of chemicals into the environment has increased dramatically in recent years. Microorganisms inhabit almost every environment on the Earth's surface and play important roles in biogeochemical processes and ecosystem function. Our overall research interest is to understand the complex interactions of microbial community functions and geochemical processes, both of which are influencing each other co-dependently to shape the ecosystem. We are working with natural or anthropogenically-impacted systems to study function and diversity of microbial community in context of ecosystem function, interaction with environmental factors, and physiochemical changes. Interdisciplinary knowledge and research efforts are necessary to link genomics, ecology, and geochemical processes associated with microbial functions in the environments. Topics: 1. Environmental microbiology. 2. Geomicrobiology of metalloids. 3. Microbe-mineral interactions. 3. Microbial ecology in the extreme environment.	Lab work experience (preferably in the areas of microbiology, molecular biology, and/or geochemical analyses) and knowledge of microbiology.	1	bioremediation microbial metal transformation microbial electrochemistry microbial ecology environmental microbiology geomicrobiology		
	<input type="checkbox"/>	<input type="checkbox"/>	<input type="checkbox"/>										
	<input type="checkbox"/>	<input type="checkbox"/>	<input type="checkbox"/>										
	<input type="checkbox"/>	<input type="checkbox"/>	<input type="checkbox"/>										
SC24011	<input type="checkbox"/>	<input type="checkbox"/>	<input type="checkbox"/>	Eriko	Sasaki	Science	Biology	Our research focuses on the genetic basis of natural variation, such as flowering phenology and genome defense systems, mainly in Europe populations of <i>Arabidopsis thaliana</i> . We aim to understand how plants have adapted to various environmental conditions using genomics, quantitative genetics, and molecular biology approaches. Website ( <a href="https://sites.google.com/view/enikosasaki-research/home-en">https://sites.google.com/view/enikosasaki-research/home-en</a> )		2	Evolution Plants Quantitative genetics Epigenetics		
	<input type="checkbox"/>	<input type="checkbox"/>	<input type="checkbox"/>										
	<input type="checkbox"/>	<input type="checkbox"/>	<input type="checkbox"/>										
	<input type="checkbox"/>	<input type="checkbox"/>	<input type="checkbox"/>										
SC24012	<input type="checkbox"/>	<input type="checkbox"/>	<input type="checkbox"/>	Arakaki	Seiji	Science/ System Life Science	Biology/ System Life Science	Our laboratory, the Amakusa Marine Biological Laboratory, is located in western Kyushu (far away from the main campus). The AMBL aims at elucidating how a multitude of species can coexist and maintain ecological assemblages under different environmental conditions and evolutionary backgrounds. (Website) <a href="http://amb-hu.jp/">http://amb-hu.jp/</a>		1	Marine Community Ecology Coastal Ecosystems		
	<input type="checkbox"/>	<input type="checkbox"/>	<input type="checkbox"/>										
	<input type="checkbox"/>	<input type="checkbox"/>	<input type="checkbox"/>										
	<input type="checkbox"/>	<input type="checkbox"/>	<input type="checkbox"/>										
MA-24001	<input type="checkbox"/>	<input type="checkbox"/>	<input type="checkbox"/>	Masato	Tsujii	Mathematics	Mathematics	I am interested in dynamical systems, which describes deterministic time evolutions that appear in many fields of sciences. More specifically I am studying smooth ergodic theory which describes long-time statistical properties of dynamical systems generated by smooth vector fields or smooth maps.	Calculus and Linear Algebra	2	Dynamical System Ergodic Theory Chaos Fractal Strange Attractor Fractal dimension		
	<input type="checkbox"/>	<input type="checkbox"/>	<input type="checkbox"/>										
	<input type="checkbox"/>	<input type="checkbox"/>	<input type="checkbox"/>										
	<input type="checkbox"/>	<input type="checkbox"/>	<input type="checkbox"/>										

Kyushu University Program for Emerging Leaders in Science (Q-PELS)\_AY2024

Course code	Category			Course			Host Laboratory Information			Research Description	Pre-Requisites	Maximum number of participants per period	Keywords
	TYPE1 32days-3months	TYPE2 Semester Fall 2024	TYPE3 Full-year Fall 2024-Spring 2025	Undergraduate	Graduate	Faculty Member(s)							
						Surname	First Name	Department					
MA24002	<input type="radio"/>	<input type="radio"/>	<input type="radio"/>	<input type="radio"/>	<input type="radio"/>	Kajiwara Kenji	Mathematics	Mathematics	Differential geometry of smooth/discrete curves and surfaces, integrable systems, geometric shape generation. Applications to architecture design and industrial design.	Knowledge of fundamental calculus, linear algebra, differential equations, and preferably, geometry of curves and surfaces.	1	Curves and Surfaces Integrable Systems Geometric Shape Generation Differential Geometry	
MA24003	<input type="radio"/>	<input type="radio"/>	<input type="radio"/>	<input type="radio"/>	<input type="radio"/>	Kaji Shizuo	Mathematics	Mathematics	Professor Shizuo KAJI works in the field of applied topology. His research interests include topological data analysis, geometric models of graphs and other discrete structures for machine learning, and 3D shape analysis and design. Please visit his web page at <a href="https://www.skaji.org">https://www.skaji.org</a> for more information.	Knowledge of undergraduate mathematics such as linear algebra, calculus, point set topology, and metric space	2	Topological Data Analysis Geometric Representation Learning Geometric Shape Design Applied Topology	
MA24004	<input type="radio"/>	<input type="radio"/>	<input type="radio"/>	<input type="radio"/>	<input type="radio"/>	CESANA Pientugi	Mathematics	Mathematics	My Lab focusses on two main lines. 1) (more classical) Partial Differential Equations and Continuum Mechanical models for smart materials. This includes Shape Memory Alloys, Liquid crystals and more. Some of this work in collaboration with Caltech and Oxford groups. See: <a href="https://arxiv.org/abs/2207.02511">https://arxiv.org/abs/2207.02511</a> <a href="https://arxiv.org/abs/1501.06859">https://arxiv.org/abs/1501.06859</a> 2) Artificial Intelligence and Machine Learning methods for the accelerated design of molecules and materials for targeted applications in electronics, semiconductors, etc. See: <a href="https://linkinghub.elsevier.com/retrieve/pii/S2666827022000093">https://linkinghub.elsevier.com/retrieve/pii/S2666827022000093</a>	Flexible as various projects will be available based on each student's background.	2	Partial Differential Equations Plasticity Dislocation Discination Liquid crystals Continuum Mechanics Calculus of Variations Cellular Automata Machine Learning Quantum chemistry Density Functional Theory	
MA24005	<input type="radio"/>	<input type="radio"/>	<input type="radio"/>	<input type="radio"/>	<input type="radio"/>	Hiroshima Fumio	Mathematics	Mathematics	I am studying the spectral analysis of operators on an infinite dimensional space. Especially, from the mathematical standpoint, we investigate the quantum field theory on pseudo-Riemannian manifolds by using operator theory, micro-local analysis, theory of one-parameter semigroup, stochastic analysis, functional integral.	Knowledge of measure theory, linear algebra, general topology	1	quantum field theory path integral functional analysis spectral analysis measure theory mathematical physics	
MA24006	<input type="radio"/>	<input type="radio"/>	<input type="radio"/>	<input type="radio"/>	<input type="radio"/>	Ochiai Hiroyuki	Mathematics	Mathematics	Professor Ochiai works on Algebraic Analysis, including Special Functions, Hypergeometric functions, Representation Theory of Lie groups and Lie algebra, D-modules	Calculus and Linear algebra are necessary.	2	Algebraic Analysis D-module hypergeometric function spherical function Hecke algebra Lie group	



Kyushu University Program for Emerging Leaders in Science (Q-PELS)\_AY2024

Course code	Category			Course			Host Laboratory Information			Research Description	Pre-Requisites	Maximum number of participants per period	Keywords
	TYPE1	TYPE2	TYPE3	Faculty Member(s)		School/ Graduate school	Department						
	32days-3months	Semester Fall 2024	Full-year Fall 2024- Spring 2025	Surname	First Name								
MA24007	<input type="radio"/>	<input type="radio"/>	<input type="radio"/>			Mathematics	Mathematics	Nguyen	Dirh Hoa	Professor Nguyen's research is on the modelling, optimization and control towards clean and autonomous power and energy systems. His particular interests are on distributed control and optimization; multi-agent systems; integration of renewable and distributed energy resources; stability, robustness and resiliency of smart grids. For more details, please see: <a href="https://sites.google.com/site/dinhhoanguyenai">https://sites.google.com/site/dinhhoanguyenai</a>	1	Control Theory Smart Grid Optimization Multi-Agent System Renewable and Distributed Energy Resources Artificial Intelligence Dynamical Systems Numerical Analysis Singular Perturbation, Blow-up Complex Systems involving Combustion	
MA24008	<input type="radio"/>	<input type="radio"/>	<input type="radio"/>			Mathematics	Mathematics	Matsue	Kaname	Research interests in this Lab are mainly twofolds. 1: Dynamical Systems. Based on (ordinary) differential equations, various complex, singular behavior are studied. Recently, blow-up solutions and singular perturbation problems are mainly studied. 2: Numerical Analysis with application to dynamical systems. Singular nature in dynamical systems is also studied from the viewpoint of numerics. Numerical difficulties in these problems are our issues here. As an application, the following topic is also studied. 3: Combustion.	1	Knowledge of undergraduate level mathematics. Basic programming skills (like C or Python) are preferable to have. Students who are interested in Topic 1 (in Research Description) are strongly welcome.	
MA24009	<input type="radio"/>	<input type="radio"/>	<input type="radio"/>			Mathematics	Mathematics	Fukumoto	Yasuhide	This course is to conduct a mathematical modeling of fluid phenomena in terms of partial differential equations, an asymptotic analysis for getting an essential information of their solution and a numerical calculation of the full solution, experience, with its feedback to the phenomena. Specific targets are vortex dynamics, stability of fluid motions, magnetohydrodynamics, flows through porous media, flood of rivers, combustion.	2	Fluid mechanics Hamiltonian mechanics Hydrodynamic stability Vortex motion Magnetohydrodynamics Combustion	
MI24001	<input type="radio"/>	<input type="radio"/>	<input type="radio"/>			Agro-Environmental Sciences	Joint Graduate School of Mathematics for innovation	Ta	Ton	Mathematical Modeling Lab website: <a href="http://www.agr.kyushu-u.ac.jp/lab/maz/">http://www.agr.kyushu-u.ac.jp/lab/maz/</a> We study various real-world phenomena by using stochastic ordinary/partial differential equations, statistical models, or deep learning. Some topics include Fish Schooling, Forest Ecosystem, Weather Prediction.	2	Stochastic differential equations Fish schooling Deep learning Applied statistics Forest ecosystem Stochastic evolution equations	
SL24001	<input type="radio"/>	<input type="radio"/>	<input type="radio"/>			System Life Science	System Life Science	Kenshi	Hayashi	Hayashi Lab/Organic Electronics Lab is focused on bio-mimetic/organic material devices, which detect odor information. Especially, odor imaging device for robotic application based on two dimensional plasmonic materials and molecular selective materials, which realize high-sensitive, high-speed and high throughput visualize spatiotemporal changes of chemical space. Fully inkjet printed sensor devices are also researched.	2	gas sensor plasmonic device nano material IoT application sensor robot application	



Kyushu University Program for Emerging Leaders in Science (Q-PELS)\_AY2024

Course code	Category			Course			Host Laboratory Information			Research Description	Pre-Requisites	Maximum number of participants per period	Keywords	
	TYPE1 32days-3months	TYPE2 Semester-Fall 2024	TYPE3 Full-year-Fall 2024-Spring 2025	Undergraduate		Graduate	Faculty Member(s)		School/Graduate school					Department
				Suriname	First Name		Suriname	First Name						
SL24002	○	○	○		○	○	Iramina	Kelji	System Life Sciences	System Life Sciences	System Life Sciences	4	Neuroimaging Neuroengineering Biomedical engineering	
SL24003	○	○	○		○	○	Lauwereyns	Johan	Systems Life Sciences	Systems Life Sciences	Systems Life Sciences	2	Bioethics Cognitive biases Meta-decision-making	
SL24004	○	○	○			○	Arata	Jumppei	Systems Life Sciences	Systems Life Sciences	Systems Life Sciences	1	Robotics Medical Application Surgical robots Rehabilitation robots Bio sensors Brain-Machine Interface	
SL24005	○	○	○			○	Katayama	Yoshiki	Systems Life Sciences	Systems Life Sciences	Systems Life Sciences	1	Biomedical/Bioengineering Analytical Chemistry Immunology Formulation Technology Macromolecular/Supramolecular Science Artificial Cells	

# Japanese Language Learning Opportunities for Exchange Students

## 交換留学生のための日本語授業について

### Kyushu University International Student Center

The International Student Center offers the country's top-rated Japanese language courses for international students both for credit and for training purposes. Please take full advantage of these courses during your study period at Kyushu University.

九州大学留学生センターでは、九州大学に在籍する留学生を対象に、国内トップクラスの日本語授業を、単位の取得や語学力の研鑽のために提供しています。ぜひこの機会を利用し、日本語の学習に役立ててください。

<https://isc.kyushu-u.ac.jp/center/international/japaneselang/>



### Ito Campus

Two types of Japanese language curricula are available at Ito Campus as described below, and exchange students may choose courses based on their circumstances and needs including their proficiency levels, interest in earning credits, and time-availability to focus on the language learning, among others.

伊都キャンパスでは、以下のとおり2種類の日本語コースを提供しており、日本語の習熟度、単位取得の必要性や、日本語学習にかけられる時間など、個別の状況に応じてコースを選択することができます。

#### 1. Japanese Academic Courses (JACs) 日本語アカデミックコース

JACs are for students who want to earn credits in Japanese language. These courses consist of four types – comprehensive Japanese, kanji, conversation, and composition – and offer up to eight levels of learning, ranging from absolute beginners to advanced learners.

JACsは、日本語の単位を取得したい留学生のためのコースで、総合日本語、漢字、会話、作文の4つのコースから構成されています。クラスは8つのレベルに分かれており、全くの初心者から上級者までが学習できる授業内容を提供しています。

<https://isc.kyushu-u.ac.jp/center/jacs/>



#### 2. Japanese Training Courses (JTCs) 日本語課外補講コース

JTCs are for training purposes, not for credit, offered primarily to graduate students, research students, and exchange students at both undergraduate and graduate levels. Through JTCs, comprehensive Japanese courses are offered from Level 1 up to Level 7 (from absolute beginners to advanced learners). JTCs are recommended to exchange students who are interested in taking Japanese language courses but are not in need of earning credit in those courses.

JTCsは、主に大学院生、研究生、交換留学生(学部・大学院レベル)を対象にした、単位取得を目的としないコースです。レベル1からレベル7までの全くの初心者から上級者までを対象とした、総合的な日本語の授業を提供しています。日本語は学習したいが単位取得の必要はないという交換留学生の方にお勧めです。

<https://isc.kyushu-u.ac.jp/center/jtcs/>





# LIVING EXPENSES, SCHOLARSHIP, ACCOMMODATION and VISA

生活費、奨学金、  
ドミトリー、  
ビザ手続きなど

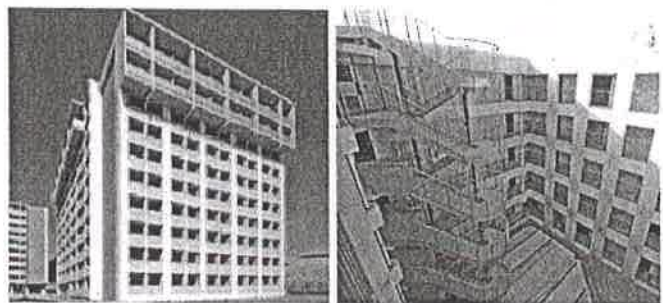

## ■ 1. Estimated Living Expenses in Fukuoka / 福岡市での生活費の目安 ■

Living costs are significantly reasonable in Fukuoka compared to other big cities, such as Tokyo, Osaka and Nagoya. You will need between 80,000 and 115,000 yen a month to live in depending on your dormitory room choice and habitual use of water and electricity, which varies greatly between individuals.

福岡での生活費は、東京、大阪、名古屋などの大都市と比べるとかなり安価です。個人差はありますが、寮の部屋のタイプや、水道・電気の使用量などによって、だいたい1ヶ月に8万円から11万5千円程度かかります。

Approximate Living Expenses/ Month	
Housing and Utilities	15,000 - 50,000 yen
Food	30,000 yen
Personal Expenses	20,000 yen
Public Transportation	10,000 yen
Books and Supplies	5,000 yen
National Health Insurance	2,000 yen
Emergency Security Plan (ESP)	1,000 yen / year
<b>Total</b>	<b>Approx. 80,000 - 115,000 yen</b>

おおよその生活費の目安 / ひと月当たり	
住宅費・光熱費	15,000円~50,000円
食費	30,000円
諸経費(小遣いなど)	20,000円
交通費	10,000円
書籍等	5,000円
国民健康保険	2,000円
外国人留学生等 緊急安心プラン	1,000円 (年間)
<b>合計</b>	<b>約80,000円~115,000円</b>



## ■ 2. Scholarship / 奨学金 ■

Most major scholarship for exchange students is JASSO (Japan Student Services Organization) scholarship. Applicants may apply for along with the Kyushu University exchange application procedures. 80,000 yen/month will be granted as a financial support for your student life in Kyushu if you are selected as a recipient. (The number of recipients differs depending on year /semester.)

If you apply for JLCC (Japanese Language and Culture Course), you may be eligible for MEXT (Ministry of Education, Culture, Sports, Science and Technology) Scholarship.

交換留学生の方にとって、最もメジャーな奨学金は、日本学生支援機構(JASSO)奨学金です。九州大学への交換留学生申請の際に、併せて応募することができます。奨学生に選ばされると、交換留学中の生活費を支援するため、月額80,000円が支給されます。(支給人数は年度や学期によって異なります)。

また、JLCC(日本語・日本文化研修コース)への申請者は、文部科学省奨学金(国費外国人留学生奨学金)への応募が可能な場合もあります。

[https://www.mext.go.jp/a\\_menu/koutou/ryugaku/06032818.htm](https://www.mext.go.jp/a_menu/koutou/ryugaku/06032818.htm)



## ■ 3. Accommodation / 住居 ■

Kyushu University has six dormitories for international students. There are four dormitories in Ito campus and one dormitory in Ohashi and Hospital(Maldashi) campus respectively, which are quite reasonable. Single dorm room is guaranteed for each exchange student.

九州大学には、外国人留学生用の寮が6棟あります。伊都キャンパスに4棟、大橋キャンパスと病院(馬出)キャンパスに各1棟あり、非常に安価な料金設定となっています。また、交換留学生の方には、1名につき1室シングルルームが割り当てられます。

## ■ 4. Visa Issuance / ビザの手続きについて ■

You are required to obtain "Student Visa" issued by Japanese embassy/consulate in your country of residence in order to study as an exchange student. Kyushu University will help you complete the required procedure for visa application as well as for dormitory using "Pre-Arrival Assistance" system.

日本に渡航するにあたっては、必ず居住国の日本大使館または領事館で発行される「留学ビザ」を取得する必要があります。九州大学では、交換留学生の方のビザの申請から寮の手続きまで、プレアライバルアシスタンスシステムを利用してサポートしています。

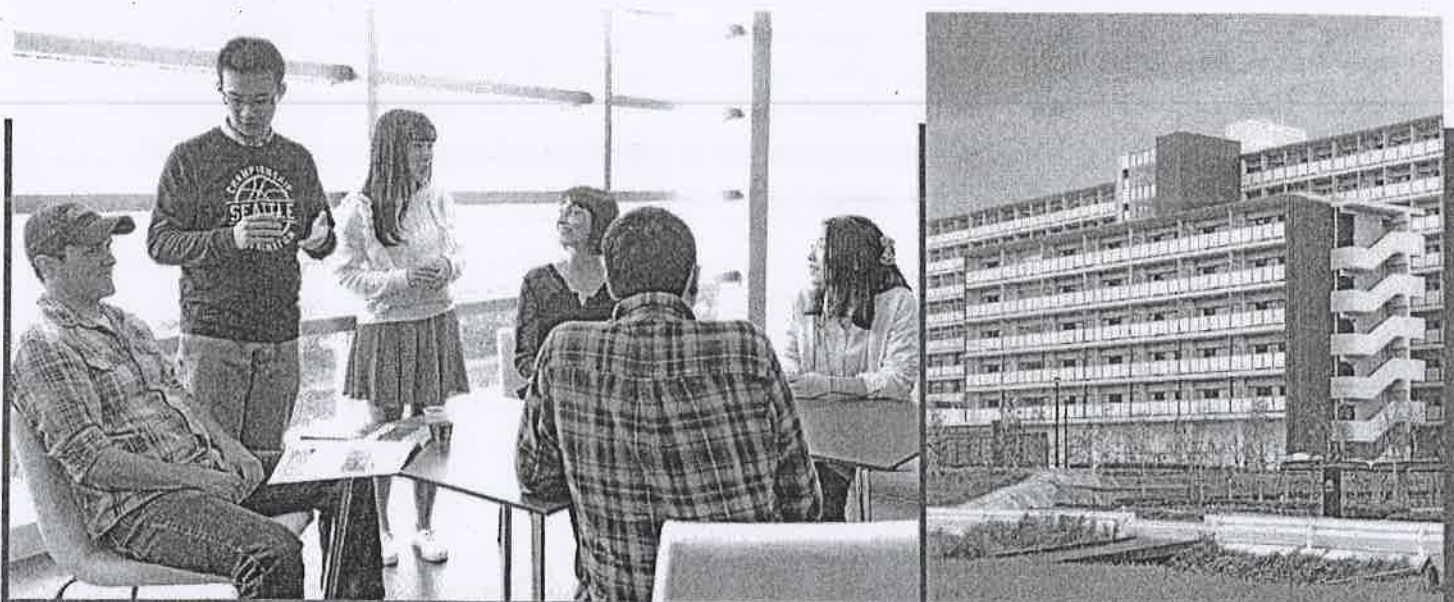



**Kyushu University**  
**Instructions of Student Exchange Program Application (For prior to application)**  
**(University-Wide)**

Read these instructions carefully **before** applying for Kyushu University Student Exchange Program. Firstly, please contact the international office of your home university regarding internal selection procedure as the deadline for application may differ depending on each university.

You will be asked to complete your application using the web system by the designated deadline\*after you will be selected as a nominee by your home university. Therefore, please prepare all the required materials as indicated in the #7 well in advance. (The details of the website will be notified accordingly.)

\*For JTW/JLCC: February 10, 2024.

\*For Undergraduate/ Graduate Program and Q-PELS: March 10, 2024

Please note that we **DO NOT** accept applications directly from individual students. You should be selected as a nominee at your home university firstly.

1. Program *Please select one program you wish to be enrolled.	
Overall Exchange Programs	<a href="https://www.isc.kyushu-u.ac.jp/intlweb/en/admission/exchangetop">https://www.isc.kyushu-u.ac.jp/intlweb/en/admission/exchangetop</a>
Japan in Today's World (JTW)	<a href="https://www.isc.kyushu-u.ac.jp/jtw/">https://www.isc.kyushu-u.ac.jp/jtw/</a>
Japanese Language & Culture Course (JLCC)	<a href="https://www.isc.kyushu-u.ac.jp/jlcc/en/">https://www.isc.kyushu-u.ac.jp/jlcc/en/</a> If applying via the Japanese embassy/consulate in your home country, please follow the instruction of the embassy/consulate.
Undergraduate School	<a href="https://www.kyushu-u.ac.jp/en/faculty/">https://www.kyushu-u.ac.jp/en/faculty/</a>
Graduate School	<a href="https://www.kyushu-u.ac.jp/en/faculty/">https://www.kyushu-u.ac.jp/en/faculty/</a>
Kyushu University Program for Emerging Leaders in Science (Q-PELS)	Please refer to the attachment.

2. Educational Background
Applicants must be enrolled in a formal degree program at his/her home university throughout the period of attendance at Kyushu University. (*Please make sure your expected graduation date as you will NOT be accepted as an exchange student after you graduate from your home university.)

3. Language Proficiency
As indicated in the Fact Sheet, applicants are required to have Japanese/ English language proficiency depending on its courses.

4. Financial Support
Please see the followings for possible scholarship information.



**JASSO (Japan Student Services Organization)**

[https://www.jasso.go.jp/en/ryugaku/scholarship\\_j/ukeire.html](https://www.jasso.go.jp/en/ryugaku/scholarship_j/ukeire.html)

**MEXT Scholarship (Japanese Government Scholarship) \*Only JLCC applicants are eligible to apply.**

[https://www.mext.go.jp/a\\_menu/koutou/ryugaku/06032818.htm](https://www.mext.go.jp/a_menu/koutou/ryugaku/06032818.htm)

You may apply for MEXT scholarship if you wish to join the JLCC program.

Please note that being nominated by Kyushu University does NOT necessarily mean that you will receive the scholarship; the final decision to be granted is made by the scholarship-sponsoring organization. We may not be able to notify you before your arrival to Japan about the result due to the procedure of the organization.

You are requested to show your intention to apply for the scholarship through the web application system.

If you have been granted with another scholarship, please make sure to notify us through the international office of your university in order to avoid the conflict of being a recipient of the JASSO or MEXT scholarship.

**5. Credits and Course List**

Please refer to the information below well in advance.

(If you are a graduate student and intend to do research only, you do not have to fill out the course list.)

<b>Course List</b>	List up names of courses you wish to take at Kyushu University in order of preference prior to the web application. You must select courses to meet 14 credits or more each semester under Japanese Immigration Law. (More than 20 credits are not recommended.) <u>Please make sure to select courses from the undergraduate/graduate school you are applying for.</u> Please note that your course request is not always accepted.
<b>Course Reference (JTW)</b>	<a href="https://isc.kyushu-u.ac.jp/jtw/program">https://isc.kyushu-u.ac.jp/jtw/program</a>
<b>Course Reference (JLCC)</b>	<a href="https://isc.kyushu-u.ac.jp/jlcc/courses">https://isc.kyushu-u.ac.jp/jlcc/courses</a>
<b>Course Reference in English (Schools/Graduate Schools)</b>	<a href="https://www.kyushu-u.ac.jp/en/faculty/class/learning/syllabus/department">https://www.kyushu-u.ac.jp/en/faculty/class/learning/syllabus/department</a> <a href="https://www.isc.kyushu-u.ac.jp/intlweb/en/student/english">https://www.isc.kyushu-u.ac.jp/intlweb/en/student/english</a>
<b>Course Reference in Japanese (Schools/Graduate Schools)</b>	<a href="https://www.kyushu-u.ac.jp/ja/faculty/class/learning/syllabus/department">https://www.kyushu-u.ac.jp/ja/faculty/class/learning/syllabus/department</a>

**6. Research**

Applicants who wish to do research in a laboratory MUST specify this section. Search instructors: [https://hyoka.ofc.kyushu-u.ac.jp/search/index\\_e.html](https://hyoka.ofc.kyushu-u.ac.jp/search/index_e.html)

<b>Field of Study</b>	Specify your field of study.
<b>Theme of Research</b>	Specify the theme of your research you wish to conduct at Kyushu University. Please note that the detailed descriptions are preferable in order to find a prospective academic supervisor.
<b>Names of Preferred Supervisors at Kyushu University</b>	<b>Make sure</b> to list up <b>3</b> instructors in order of preference based on your field of study. Please note that requests of supervisors are not always accepted.



7. Required Documents through Online Submission		
<input type="checkbox"/>	Academic Transcript	<b>All applicants</b> must submit.
<input type="checkbox"/>	Letter of Recommendation (signed by handwriting)	*Regarding "Academic Transcript", please be sure to refer to the page 4 in the "Kyushu University Fact Sheet" as you may be requested to submit the supplemental documentation to convert your score to 4.0 scale.
<input type="checkbox"/>	Passport Copy	
<input type="checkbox"/>	Study Plan	
<input type="checkbox"/>	Research Plan	<p><b>Applicants who wish to conduct research</b> must submit.</p> <p>You should describe or explain the following 2 themes either in English or Japanese in accordance with the language you will use at Kyushu;</p> <ol style="list-style-type: none"> <li>1) Your current research conducted at your home university. (200 - 250 words in English/ 400 - 450 characters in Japanese)</li> <li>2) Your field of study and describe the theme of your research that you wish to implement at Kyushu. (200 - 250 words in English/ 400 - 450 characters in Japanese)</li> </ol> <p><b>Please note that the description should be minutely and specifically, or you might not be selected.</b></p>
<input type="checkbox"/>	Copy of Diploma	<p><b>Post graduate students</b> must submit.</p> <p>*If you cannot submit the Diploma for some reasons, such as due to the educational system, please submit the certificate which proves you got the bachelor's/ master's degree.</p>
<input type="checkbox"/>	Language Proficiency Certificate	<p><b>Non-native English speakers who wish to study in English</b> must submit a score of TOEFL iBT or IELTS.</p> <p><b>Applicants who wish to study in Japanese</b> must submit Japanese Language Proficiency Test (JLPT).</p>
<input type="checkbox"/>	2 <sup>nd</sup> Letter of Recommendation (signed by handwriting)	<b>Only JTW applicants</b> must submit 2 recommendation letters in total from different instructors or academic advisors at home institution.
<input type="checkbox"/>	Essay titled "Why JTW for Me and My Goals"	<b>Only JTW applicants</b> must submit. Explain in 800-1000 words why you wish to participate in JTW and what you would like to achieve through the program participation.

<input type="checkbox"/>	Independent Study Project Proposal (optional)	Applicable <b>JTW applicants</b> must submit. Describe project focus, objective, methodology, any progress to date. <a href="https://www.isc.kyushu-u.ac.jp/jtw/apply">https://www.isc.kyushu-u.ac.jp/jtw/apply</a>
<input type="checkbox"/>	Advanced Laboratory Research Project Proposal (optional)	Applicable <b>JTW applicants</b> must submit. Describe project focus, objective, methodology, any progress to date. <a href="https://www.isc.kyushu-u.ac.jp/jtw/apply">https://www.isc.kyushu-u.ac.jp/jtw/apply</a>
Please note that all required documents should be written in English or Japanese. Please attach a translated version into English or Japanese if a document written in a language other than English or Japanese.		

#### 8. Reasonable Accommodations for Students with Disabilities

Kyushu University seeks to ensure that all members of Kyushu University respect the rights of people with disabilities, and accepts the request for reasonable accommodations concerning classes, exams, and daily life for students with disabilities. If you are currently receiving reasonable accommodations from your home university because of disabilities, please request for reasonable accommodations through online application form. \*Kyushu University might not be able to meet all your requests.

#### 9. Privacy Policy

Please click the following link to check Kyushu University's privacy policy before completing your application.  
<https://www.kyushu-u.ac.jp/en/website/privacypolicy>

Your consent will be requested for two items: the sending of your transcript records issued by Kyushu University to your home university and the sharing of information about your daily life at Kyushu University with your home university for administrative and safety purposes.

End of Instructions

